

Clara A Mundy Survey No 110

N 87° 31' 30" E

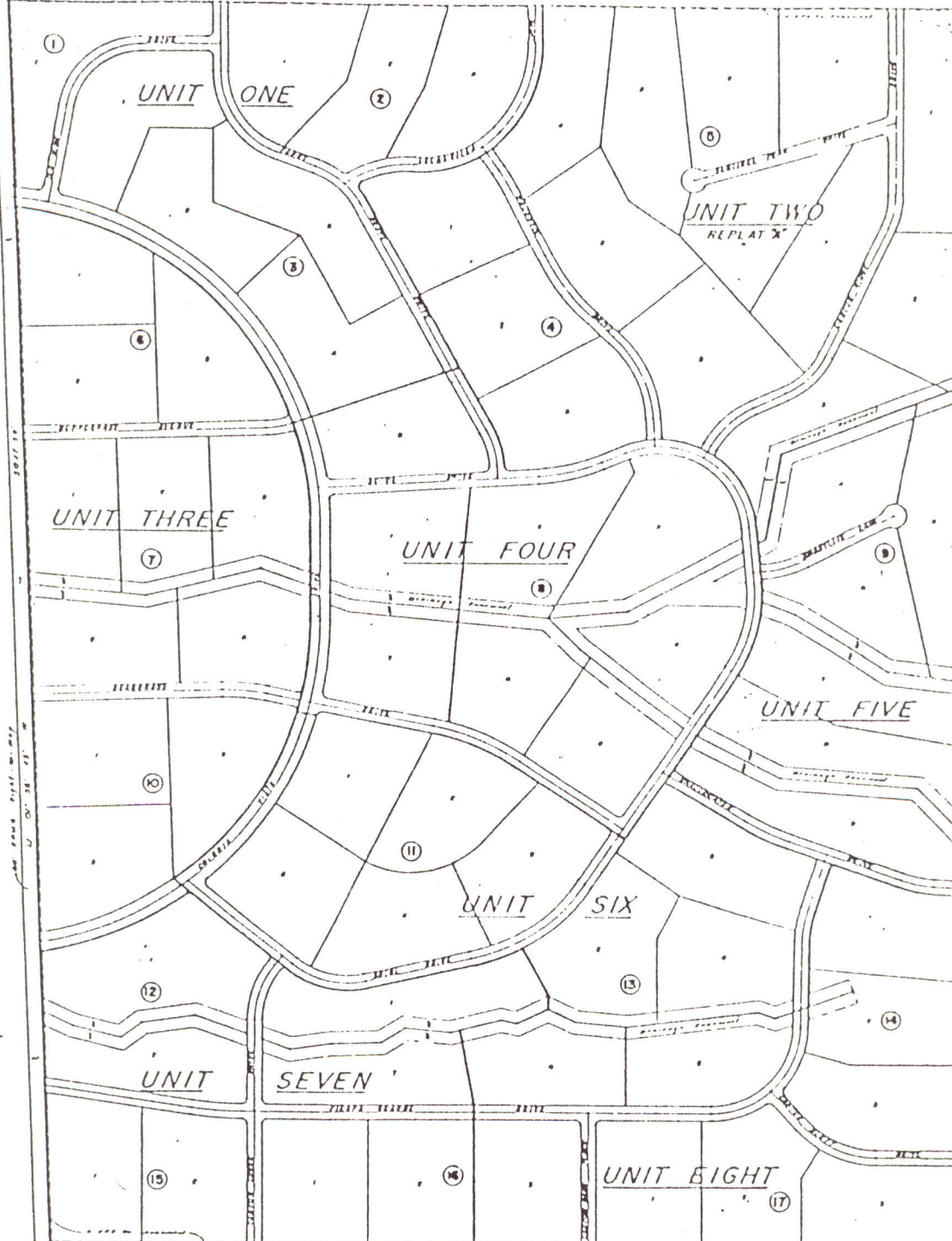

Maria Rodriguez Survey No 35

Clara A Mundy Survey No 110

COLONIA VISTA

MASTER PLAN
SCALE 1" = 200'

Maria Rodriguez Survey No 35

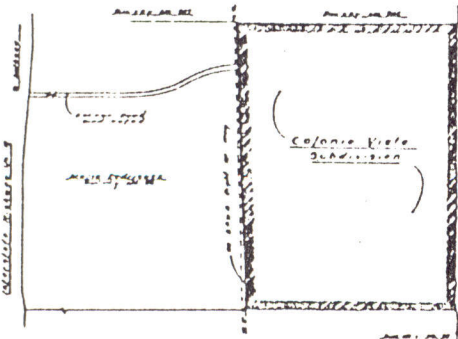

PORTION OF MARIA RODRIGUEZ
SURVEY NO 35
EL PASO COUNTY, TEXAS
CONTAINING 433.640 ACRES